

AMG260 SERIES INDUSTRIAL 1+1 MEDIA CONVERTER WITH OPTIONAL 30/60/90W POE OR PD

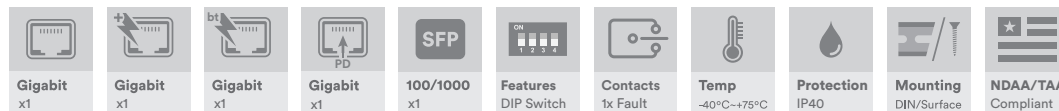

Industrial Ethernet Solutions

AMG's media converters provide 1 port of multirate 100Mb/Gigabit Ethernet uplink over fiber via the SFP port with optional 30W or 60/90W PoE or PD. Additional features are supported by user-configurable DIP switches for advanced functionality including remote device reset etc.



[AMG260-1GBT-1S-P90]

/ OVERVIEW

Designed in a compact DIN rail or wall mount housing, the AMG260 series media converters are ideally suited for connecting equipment to Ethernet networks over long distances using all types of fiber through the integrated SFP port. Fiber connectivity is determined by separate SFP device selection, providing application and site flexibility.

Available in both non-PoE models as well as PoE models for IEEE802.3at 30W or IEEE802.3bt 60/90W they are suitable for powering the latest high powered PoE devices over a wide industrial operating temperature range. A PoE PD powered model is also available for installation in locations without any local power.

User selectable DIP switches allow for configuration of the intelligent link fault pass-through feature for remote end failure detection as well as remote device reset to allow end device reboots from the control room and 250M extended distance mode on the RJ45 port.

A wide range of models are available to suit all design requirements and are fully compatible with all of the AMG250/260/260B/260M model ranges.

/ FEATURES

- Compact size – ideal for confined spaces, including camera housings and roadside cabinets
- -40°C to +75°C temperature maintains performance in extreme conditions
- DIN rail or wall mountable - quick to install and remove for maintenance (an optional magnetic mount is also available)
- All SFP ports are multirate 100Mb/Gigabit – support single and multimode, single or dual fiber options up to 120Km
- DIP switch selection of link fault pass-through, remote device reset and extended distance etc.
- Supports optional 15W, 30W, 60W and 90W PoE
- Auto-Negotiation (802.3u) – automatically determines the best connection speed
- Designed in the USA & UK. Manufactured in the United Kingdom
- AMG Lifetime Support Warranty

Specifications.

Standards.

IEEE802.3i	10Base-T
IEEE802.3u	100Base-TX & 100Base-FX
IEEE802.3ab	1000Base-T
IEEE802.3z	1000Base-X
IEEE802.3af	15W PoE
IEEE802.3at	30W PoE+
IEEE802.3bt	60 & 90W PoE
IEEE802.3x	Flow Control

Jumbo Frames	9.2Kbytes
Address Table	2K MAC Entries

Interface.

LED Indicators	2x Power Status SFP Link/Activity RJ45 Link/Activity PoE or PD Alarm
RJ45 Ports	1x 10/100/1000T(X) RJ45 with Auto MDI/MDI-X and 2 kV Isolation Protection
SFP Slot	1x 100/1000FX SFP
Power	2x 2-way Screw Terminal
Fault Relay	1x 4-way Screw Terminal

Switches.

Switch	1x 10 Position DIP Switch (Optional DIP Switch Security Cover Is Available)
Switch Functions	Local/Remote Mode Link Fault Pass-Through Mode Remote Reset Mode Extended Distance Mode SFP Alarm

Packaging.

Shipping Weight:	0.57kg / 1.26lb
Dimensions:	(W x D x H) 220 x 170 x 40 mm 8.66 x 6.69 x 1.57 in

Power.

Power Inputs	2
Operating Voltage:	
Non-PoE Models	12-56V _{DC}
30W PoE Models	48-56V _{DC}
90W PoE Models	52-56V _{DC}
PoE PD Models	IEEE 802.3af Class 1 Device
Power Consumption	2.5W Max (without PoE Load)
PSE Modes:	
30W Models	Mode A
60/90W Models	Mode A, Mode B
Protection	Reverse Polarity Overload Current

Mechanical.

Housing	Anodised Aluminium
Dimensions:	(W x D x H) 36 x 88 x 107 mm 1.42 x 3.46 x 4.21 in
IP Rating	IP40
Installation	Wall Mount or DIN-Rail Optional Magnetic Mounts
Weight	0.44kg / 0.97lb

Environmental.

Operating Temp.	-40 to +75°C / -40 to +167°F
Storage Temp.	-40 to +85°C / -40 to +185°F
Humidity	5% to 95% (non-condensing)
MTBF	>500,000 hours
MTBF Standard	Telcordia SR-332 GF 30°C
Heat Dissipation	17 BTU/h (Non-PoE & PD) 119 BTU/h (30W PoE Models) 324 BTU/h (90W PoE Models)
Cooling	Passive Cooling
Noise Level	0 dBA

Specifications.

Regulatory.

<p>Safety EMI</p> <p>EMS</p>	<p>IEC/EN 62368-1</p> <p>EN 55032 Class A</p> <p>CISPR 32</p> <p>FCC Part 15B Class A</p> <p>EN 61000-4-2 (ESD)</p> <p>EN 61000-4-3 (RS)</p> <p>EN 61000-4-4 (EFT)</p> <p>EN 61000-4-5 (Surge)</p> <p>EN 61000-4-6 (CS)</p> <p>EN 61000-4-8 (PFMF)</p>	<p>Shock</p> <p>Free Fall</p> <p>Vibration</p> <p>Environmental</p> <p>Supply Chain</p> <p>Designed to meet NEMA TS2 & EN 50121-4</p>	<p>IEC 60068-2-27</p> <p>IEC 60068-2-32</p> <p>IEC 60068-2-6</p> <p>Reach</p> <p>RoHS</p> <p>WEEE</p> <p>NDA & TAA Compliant</p>
------------------------------	--	---	--

Application Diagram.

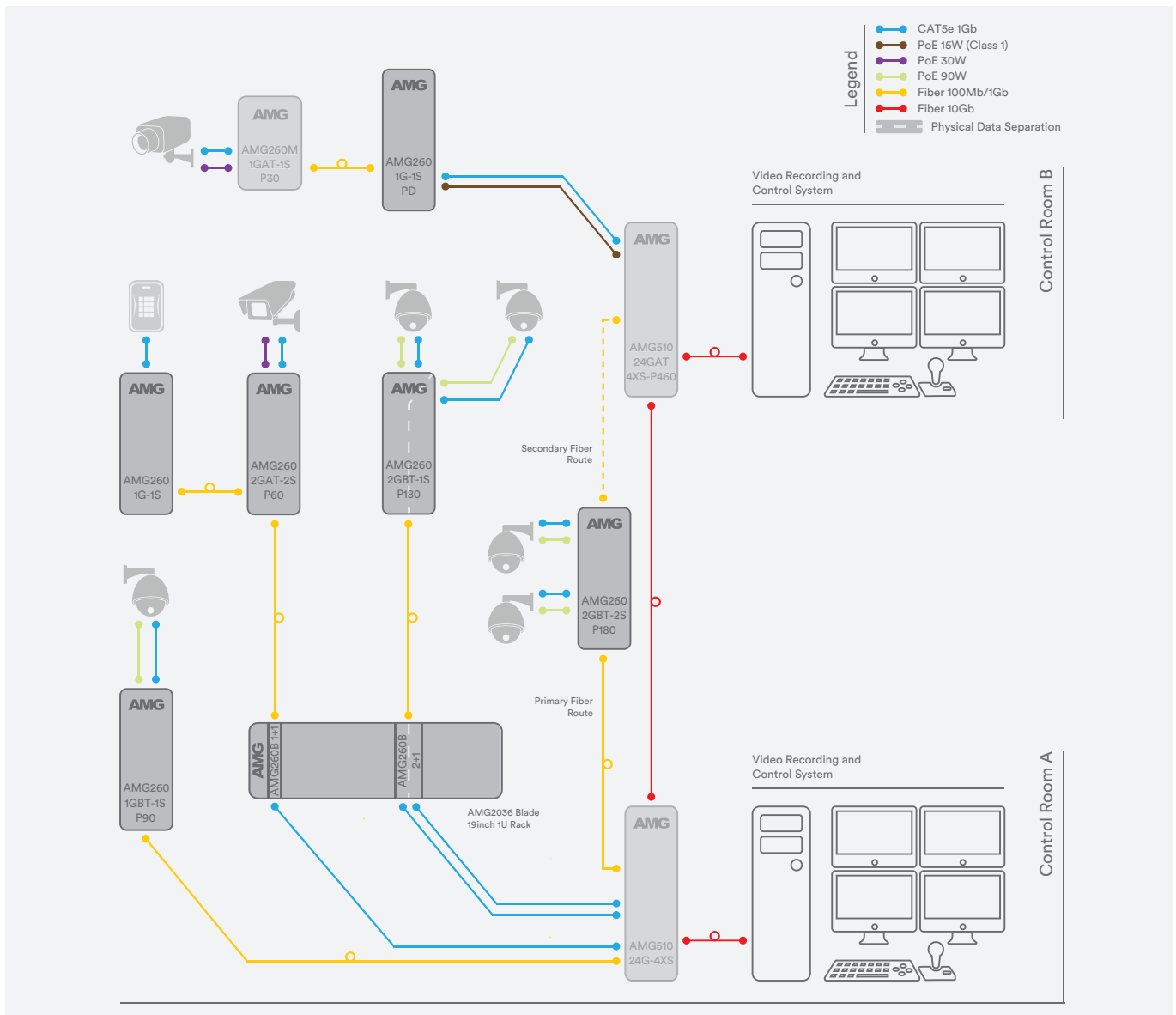

Part Numbers.

Single Port Media Converters (1+1)

AMG260-1G-1S*	1 × 10/100/1000BaseT(x) RJ45, 1 × 100/1000BaseFx SFP
AMG260-1GAT-1S-P30*	1 × 10/100/1000BaseT(x) RJ45 with 30W PoE+, 1 × 100/1000BaseFx SFP
AMG260-1GBT-1S-P90*	1 × 10/100/1000BaseT(x) RJ45 with 60/90W PoE, 1 × 100/1000BaseFx SFP
AMG260-1G-1S-PD*	1 × 10/100/1000BaseT(x) RJ45 with PoE PD Class 1 Input, 1 × 100/1000BaseFx SFP

* For conformal coated circuit boards please add /C to the end of the part code. For example AMG260-1GBT-1S-P90/C

Included Accessories.

DIN Rail Adapter Rear Mounted Metal DIN Rail Clip & Screws For DIN Rail Mounting AMG260 Series Products
 Wall Mounting Brackets 2x Wall Mounting Brackets & Screws For Wall / Surface Mounting AMG260 Series Products

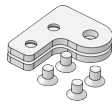
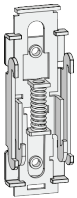

Optional Accessories.

AMG260-DIPCOVER 10-Way DIP Switch Security Cover With T8 Allen Key For AMG260 Series, need to be ordered separately
 AMGMNT-MAG-04 4x Rear Mounted Magnets & Screws Kit For AMG260 Series, need to be ordered separately
 AMG2035 Side Mounted Wall Bracket Adapter Kit For DIN Rail Mounting AMG260 Series Products In Depth Restricted Installations.
 Adapter Kit Can Be Extended Using The Included Extension Kit To Also Mount A DIN Rail Power Supply Up To 480W
 SFP Modules 100Mb & 1Gb Optical/Copper Modules see separate list, need to be ordered separately

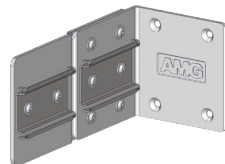
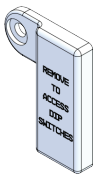

Recommended PSUs.

Non-PoE Models

AMGPSU-W12-P25 Plug Top Mounting Lite Industrial Grade PSU, 0 to +70°C, 12VDC, 25W, UK/EU/US Plug Heads Included
 AMGPSU-I12-P24A DIN-Rail Mount Industrial Grade PSU, -25 to +70°C, 12VDC, 24W*

PoE Models

AMGPSU-I48-P60A DIN-Rail Mounting Industrial Grade PSU, -40 to +70°C, 43-55VDC, 60W*
 AMGPSU-I48-P120A DIN-Rail Mounting Industrial Grade PSU, -40 to +70°C, 48-55VDC, 120W**

* Also available in kit form including mains line cord, DC cable and DIN rail. Order with -K at the end of the part code (e.g. AMGPSU-I48-P120A-K).

^ Also available with no exposed mains terminals and direct IEC input kit. Order with -IEC at the end of the part code (e.g. AMGPSU-I48-P120A-IEC).

In a continuing effort to improve and advance technology, product specifications are subject to change without notice. Please visit www.amgsystems.com for the latest product specifications.

Proud to be a British
 Manufacturer 

AMG Systems Ltd. 4 Pioneer Way, Castleford, WF10 5QU, UK T: +44 (0) 1767 600 777 E: sales@amgsystems.com
 AMG Systems Inc. 62 Spring Hill Road, Trumbull, CT 06611, USA T: +1-855-AMGPOE1 (855-264-7631) E: usasales@amgsystems.com
 D33638-03 amgsystems.com

